



1064nm 3-port Optical Circulator for Pulse Power

FEATURES

- High Isolation
- Low Insertion Loss
- Epoxy-Free Optical Path
- High Reliability and Stability
- Low Profile Packaging

APPLICATIONS

- Fiber Optic Amplifiers
- Fiber Optic Instruments
- WDM Systems
- Dispersion Compensation
- Light Routing

SPECIFICATIONS

Parameter	Unit	Value
Center Wavelength	nm	1064
Operating Wavelength Range	nm	+/-5
Insertion Loss@ 23 °C (Typ.)	dB	1.6
(1→2, 2→3) (Max.)	dB	1.8
Isolation @ 23 °C (Typ.)	dB	25
(3→2, 2→1) (Min.)	dB	23
Optical Return Loss	dB	≥45
Polarization Dependent Loss	dB	≤0.2
Fiber Type	-	HI1060 Fiber
Fiber Tensile Load	N	5
Max. Average Optical Power	W	0.5, 1, 2, 3
Max. Peak Power for pulse	kW	0.1, 1, 5, 10
Operating Temperature	°C	0~50
Storage Temperature	°C	-40~85

- Note:** 1. Specifications are for devices without the connectors
2. Devices for higher average power and higher peak power are also available per request.

PACKAGE DIMENSION

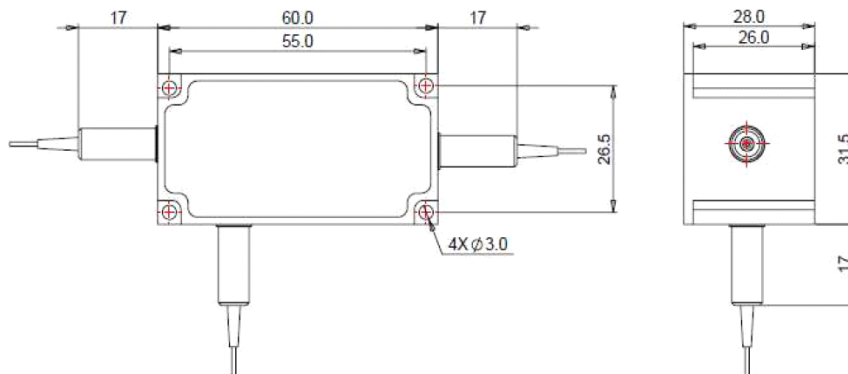

ORDERING INFORMATION

FCIR- NNNN	-H NN	P NN	- C	NN	- C
Center Wavelength	Average Power	Peak Power	Fiber Sleeve	Fiber Length	Connector Type
1064=1064nm	05=500mW 1=1W 3=3W	01=100W 1=1kW 10=10kW	B= Bare Fiber L= 900um Loose Tube	10=1.0m 15=1.5m 20=2.0m	N=Without Connector